



Open Fibre Networks

OFNL's Communal Satellite System



Communal Satellite System

Your new home is connected to entertainment services, including terrestrial TV, Freeview, and Sky Q.

You do not need an individual dish installed on your property – instead, a communal satellite dish and aerials are mounted in a central location, serving all the homes on your development. This is known as a Communal Satellite System or Fibre Integrated Reception System (FIRS) and uses the same fibre optic cables your broadband runs through.

Equipment in your home

You will already have a Gateway Terminal Unit (GTU) installed in your home. This enables you to receive Sky or terrestrial Freeview services.

You do not need your own Sky dish or aerial to receive TV. Your GTU and FIRS are supplied and managed by OFNL.



Watch our video

Watch our video online which explains how the communal satellite system works, including the in home equipment which enables you to watch TV.



Freeview
Connect a Freeview enabled TV or Freeview set-top box to the TV aerial output.



Freesat
Connect a Freesat enabled TV or Freesat set-top box to the satellite output 1 and 2.



Sky Q, Sky+, HD, 3D
Connect a Sky Q or Sky HD box to the satellite output 1 and 2.



DAB Radio
Connect a DAB radio to the DAB radio output.

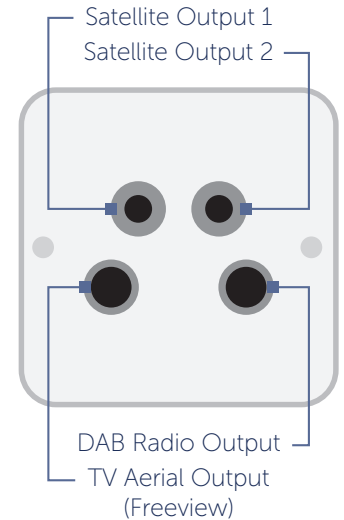

Watching digital TV on up to 3 TV's

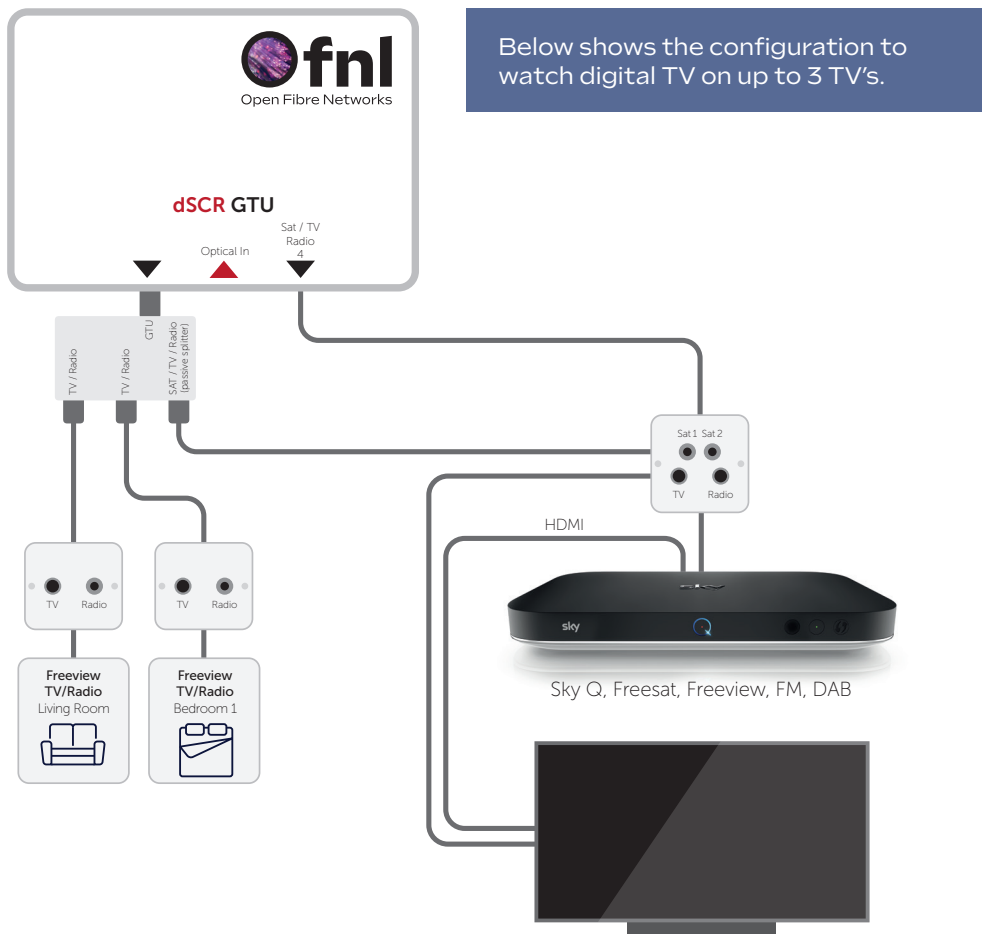

Watching digital TV on more than 3 TV's

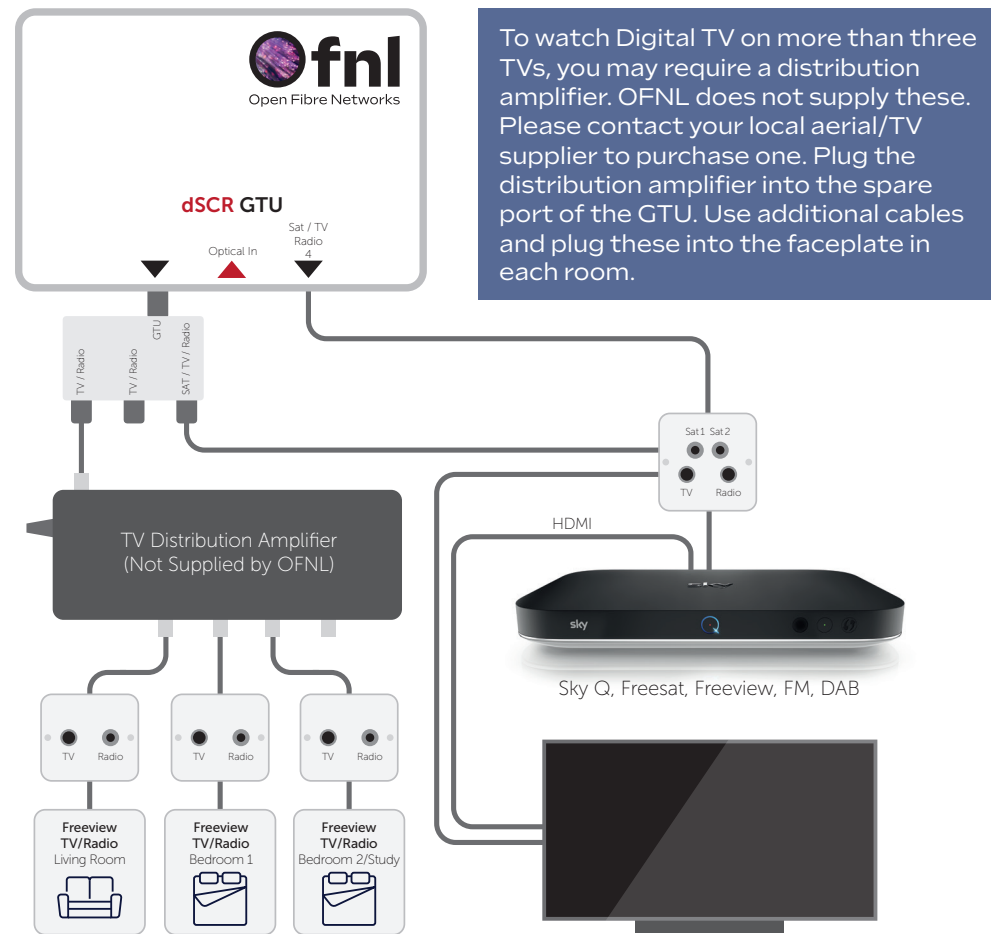

Sky engineer visit

To set up Sky TV services in your new home, a Sky engineer will need to visit to install a Sky set-top box. Please remind them you are on a communal site with FIRS. The Sky engineer will not require access to the communal satellite dish.

If you have a Quad GTU, the engineer will need to supply and connect a DCSS switch to it to allow you to receive Sky Q services.

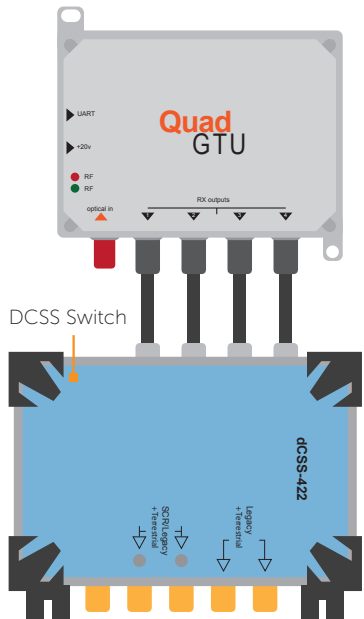

If you have a dSCR GTU, you will not need a DCSS switch to receive Sky Q services. The engineer will connect your GTU directly to your Sky Q set-top box, via your in home cabling.

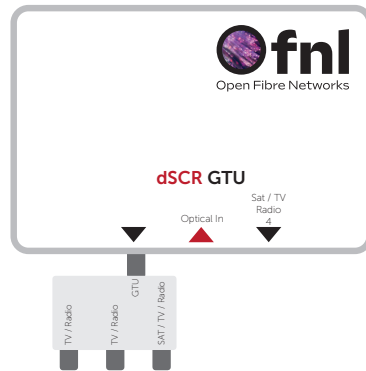

If things go wrong

If you experience issues with your TV signal, please try the below before calling OFNL:

Power down the Sky box/Freeview box and check the cables are going into the correct ports and are securely connected.

After two minutes, power up the GTU, set-top box and TV. A green or amber light on the GTU will illuminate when the power is fully restored.

Power down the GTU for five minutes.

If you are missing Freeview channels, ensure you have run the autotune feature on your TV/set-top box.

Ensure that the coax cables connecting the GTU to your home's wiring are correct and securely fastened.



If you are experiencing problems with your TV equipment, you can either watch our helpful animation video, or use our TV troubleshooting tool, where you can self-diagnose your issues, and get back to watching your favourite shows.

ofnl.co.uk/help-advice/troubleshooting-your-tv-services/



Open Fibre Networks

Contact us

02921 678 550

ofnl.co.uk/contact-us/